

MADISON COUNTY SANITARIAN'S OFFICE
103 W. WALLACE, P.O. BOX 278, VIRGINIA CITY, MT 59725
(406) 438-6400 (F) 406-843-6062

Certified Installer Report
On-Site Wastewater Treatment System

PROPERTY OWNER: LaWood PERMIT# 4321
INSTALLER NAME: Neim Const PHONE # 539-9638

SEPTIC TANK: size 500 (gallons) type conc (concrete, plastic)
baffles: yes x no no type conc (concrete, pvc)

DOSE TANK: size 500 (gallons) type plastic
DISTRIBUTION SYSTEM: distribution box: yes x no no type plastic
Manifold system: yes no Capped system: yes no

lift station: yes no type plastic
INFILTRATOR SYSTEM: yes x no no size-width of infiltrator 24"

length of each 88 width 24"
DRAINFIELD: number of laterals 3 trench depth (average) 28"
Total lineal feet 264 percent of slope 10%

Direction of slope E or W
Soil type (gravel, sand, clay, silt) Silt / Rock

Gravel size: (average) 1/2 inches Washed? yes no
Under pipe: 1/2 inches Over pipe: 1/2 inches

Cover material: untreated building paper or
2" compacted straw or porous plastic filter fabric

DISTANCE FROM WATER SOURCES: (measured by installer) 118
Owner's water supply to: septic tank 66 drainfield 118

Neighboring water supply to: septic tank 118 drainfield 118

Surface waters (streams, lakes, irrigation) to: septic tank 118 drainfield 118

Groundwater encountered? yes no at what depth? 118
Bedrock encountered? yes no at what depth? 118

I certify that this system meets the requirements of the permit issued by Madison County
Sanitarian's Office

Signature: [Signature]
Date: 10-15-23

NOTE: "As-built" plans must be submitted to the Sanitarian's Office within Ten
Days of completion.

ATTACH DIAGRAM SHOWING LOCATION AND SIZE OF SYSTEM AS INSTALLED:
(Identify location of septic tank and drainfield with distances from 2 permanent features of the lot and road.)

Kacey Smart

From: Andy Nevin <anevin88@hotmail.com>
Sent: Sunday, October 16, 2022 4:10 PM
To: Kacey Smart
Subject: Lahood





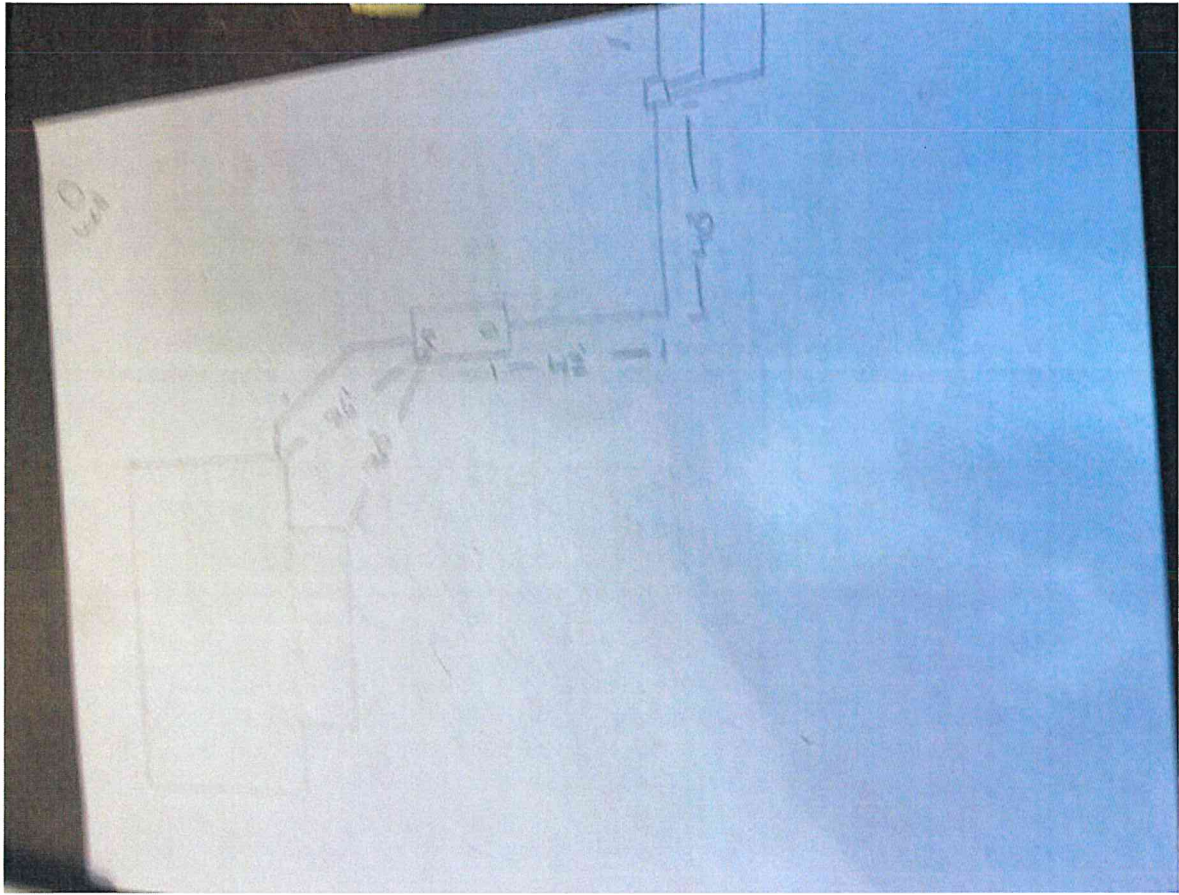

Sent from my iPhone

From: [Andy Nevin](#)
To: [Kacey Smart](#)
Subject: Lahood
Date: Sunday, October 16, 2022 4:10:25 PM









MADISON COUNTY WASTEWATER TREATMENT PERMIT

Permit to install, extend or repair septic tanks and sewage systems with inspection, in accordance covering the same. Passed by the Madison County Board of Health, Virginia City, MT, effective October 15, 1991.

This permit is issued to (installer's name): Nevin Construction

Address: PO Box 354 City: Virginia City State: MT Zip: 59755

Phone: _____

for the installation of the following sewage disposal system. System will be located on property belonging to (owner's name): Dayne LaHood

Address: 5546 Wabah St. City: Denver State: CO Zip: 80238

Phone: 720-688-1461

Legal description of property: _____ 1/4 _____ 1/4, Section 7, Township 12S, Range 2E,
consisting of 20.00 acres, located in the County of Madison, Montana.

Subdivision name: Madison River Ranches #1

Lot, Tract or Parcel, Block: Lot 45

DEQ approval number: _____

Authorized Address: 70 Flatiron Trail, Cameron

Permit issued on the 20th day of August, 20 21, for a fee of \$ 200.00

Check #: 6524 by the Madison County Sanitarian as an authorized representative for
Madison County, Montana. Receipt # a101.

SYSTEM SPECIFICATIONS

4 Bedroom house

Conventional gravity septic system

Install 1500 gallon, two-compartment concrete septic tank with effluent filter, risers as
needed and 3- 88' laterals using 22" gravelless chambers.

Construct IAW plans submitted by Barb Kingery, PE and RBK Consulting

Maintain all required setbacks IAW Madison County Wastewater System Regulations

http://madison.mt.gov/departments/sanitarian/septic/MC_Septic_System_Regs.pdf

Be safe, and contact this office prior to backfill. 406-843-4275 or 406-596-8063

~~~**As-Built plans must be submitted upon completion**~~~ of the system and  
include property boundaries, measurements to wells and streams, as well as location and design of  
the system, and north indicator.

SIGNATURE: \_\_\_\_\_

PERMIT #: 4321

Madison County Sanitarian's Office

Construction Permit #: 2734 Dated: 12/20/21 Receipt # a101

## MADISON COUNTY CONSTRUCTION & DEMOLITION APPLICATION/PERMIT

Ordinance 2-2006, effective and enforceable July 20, 2006 requiring all construction and demolition, performed in Madison County, to be subject to a fee of \$ \_\_\_\_\_. It shall be the property owner's responsibility to obtain and make restitution for a permit before commencing construction or demolition. Wastes permitted to be deposited under the terms of the permits provided by this ordinance shall be deposited only in Madison County Solid Waste Containers with the following conditions.

- All construction and demolition waste shall be cut to four (4) foot or less lengths for disposal in container sites.
- Construction and demolition waste quantities shall not exceed one pick-up truck size load per Solid Waste container per day.
- Waste shall be deposited only in Solid Waste containers.
- Any inert waste or metal goods should be taken directly to Madison County Class III landfills located in Ennis and Twin Bridges.
- Any person guilty of violating this ordinance shall be punished by a fine of not more than \$500.00 or a jail sentence of not more than 6 months or by such conditions as the court may impose.

This permit is issued to (contractor's name): Barney Construction

Address: 70 Flat Iron Trail City: Cameron State: MT Zip: 59720

Phone #: 406 581 9388 Email: Barneyconstructionmt@yahoo.com

belonging to (owners name): Dayne Schoed

Address: \_\_\_\_\_ City: \_\_\_\_\_ State: \_\_\_\_\_ Zip: \_\_\_\_\_

Phone #: 1 720 688 1461 for the following construction or demolition

located at (authorized address): 70 Flat Iron Trail Cameron MT 59720

Legal description of property: \_\_\_\_\_ 1/4 \_\_\_\_\_ 1/4, Section 7, Township 12S, Range 2E.

Subdivision name: Madison River Ranches

Lot, Tract or Parcel, Block: 45

Description of building:

☒ Single Family Residence

☐ Commercial Building

Main floor Square Footage

Second Floor Square Footage

Basement Square Footage

Garage Square Footage

Total Square Footage:

1200

400

600

2600

Square footage to include garage and finished or unfinished basements.

\*\*\*800 sq ft and under no fee\*\*\*

\$500.00 801 up to 2500 sq feet

\$550.00 2501 up to 4000 sq feet

\$600.00 4001 up to 5000 sq feet

+\$100.00 for each additional 1000 square foot increment

Fees payable to: Sanitarian's Office Mail to: Madison County Sanitarian, Box 278, Virginia City MT 59755

Application Dated: \_\_\_\_\_

New Construction: \_\_\_\_\_

Re-model: \_\_\_\_\_

Permit issued on the 20<sup>th</sup> day of December, 20 21, for a fee of \$ 550.-

check #: 6524

SIGNATURE: \_\_\_\_\_

Madison County Sanitarian's Office

Permit #: \_\_\_\_\_

002734

Septic Permit #: 4321

Date: 12/20/21



4--bedroom house (350 gpd)  
Application Rate = 0.5 gpd/ft<sup>2</sup>  
1,500 gal septic tank

3-88 foot long gravelless chambered trenches  
Onsite Septic System must be constructed  
in accordance with Circular DEQ 4 and  
Madison County Regulations

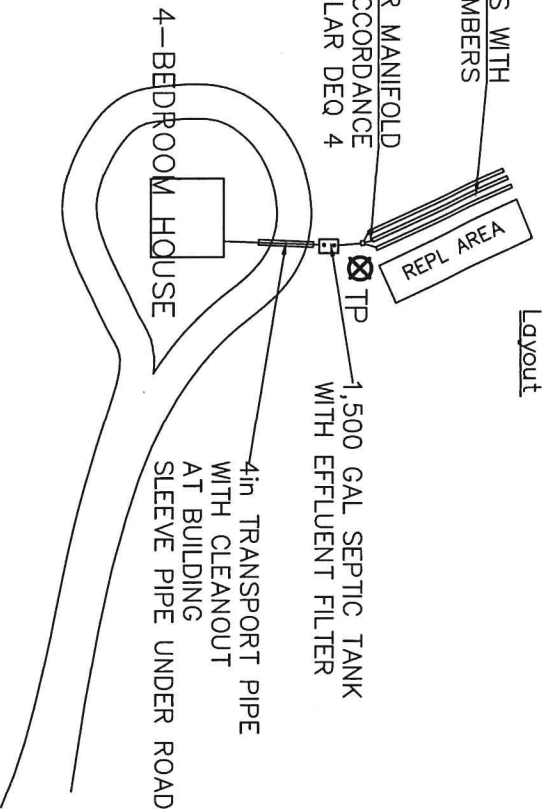

### Typical Distribution Box

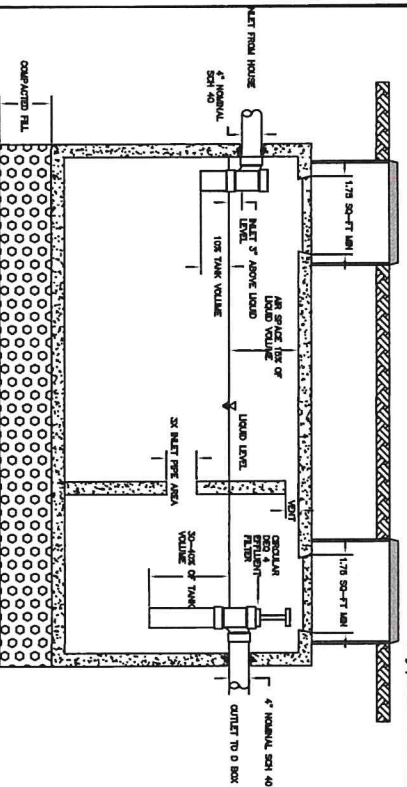

Typical 1,500 gal Concrete Septic Tank

A Thermoplastic or Fiberglass tank meeting the requirements of the most recent edition of Circular DEQ 4 may be substituted.

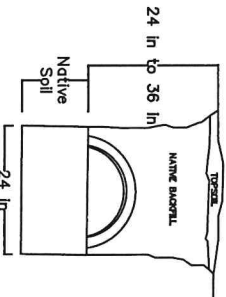

Drainfield Trench  
with Gravelless  
Chambers Detail

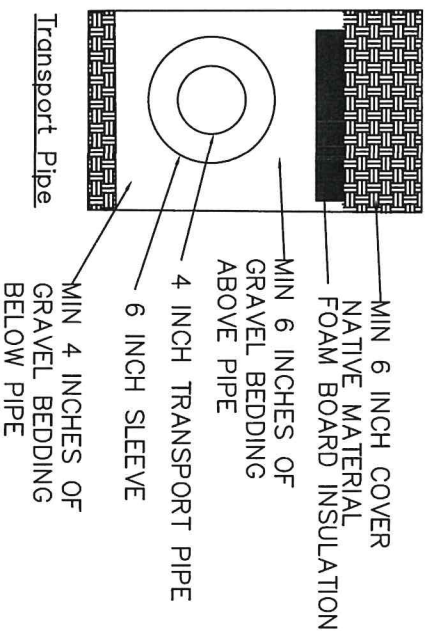

## Transport Pipe

B. Kingery  
RBK Consulting, LLC  
PO Box 1792  
Helena, MT 59624  
406.417.1281



**Not to Scale**

C.O.S. 7/859A, PARCEL 45, MADISON RIVER RANCHES

## LaHood Septic Permit - Septic System Details

FIGURE NO.

Legal Description:  
S6, T12S, R2W  
Geocode: 25-0082-07-2-01-70-0000  
70 Flatiron Trl, Cameron, MT 59720

COS 7/859A  
PARCEL 45  
20.00 AC

GROUNDWATER FLOW

1.3% Slope

500 FT  
STANDARD  
MIXING  
ZONE

SLEEVE PIPE  
UNDER ROAD  
TP

4-BEDROOM HOUSE

PROPOSED  
WELL  
LOCATION

FLATIRON TRAIL

Notes:

- Maintain setbacks in ARM 17.36.918
- Not in a mapped floodplain
- All known wells, drainfields, mixing zones and surface water within 100 feet of boundaries shown

B. Kingery  
RBK Consulting, LLC  
PO Box 1792  
Helena, MT 59624  
406.417.1281



**RBK**  
CONSULTING

0 150



scale

feet

C.O.S. 7/859A, PARCEL 45, MADISON RIVER RANCHES

Lahood Septic Permit -Lot Layout

FIGURE NO.

1